

Marke MOTOR  
 Modell Sym  
 Ausführung FIDDLE II 50 AF05W-6 (NEW ENGINE) K9-L2  
 g  
 Zeichnung 02.GILINDERKOP (21238)

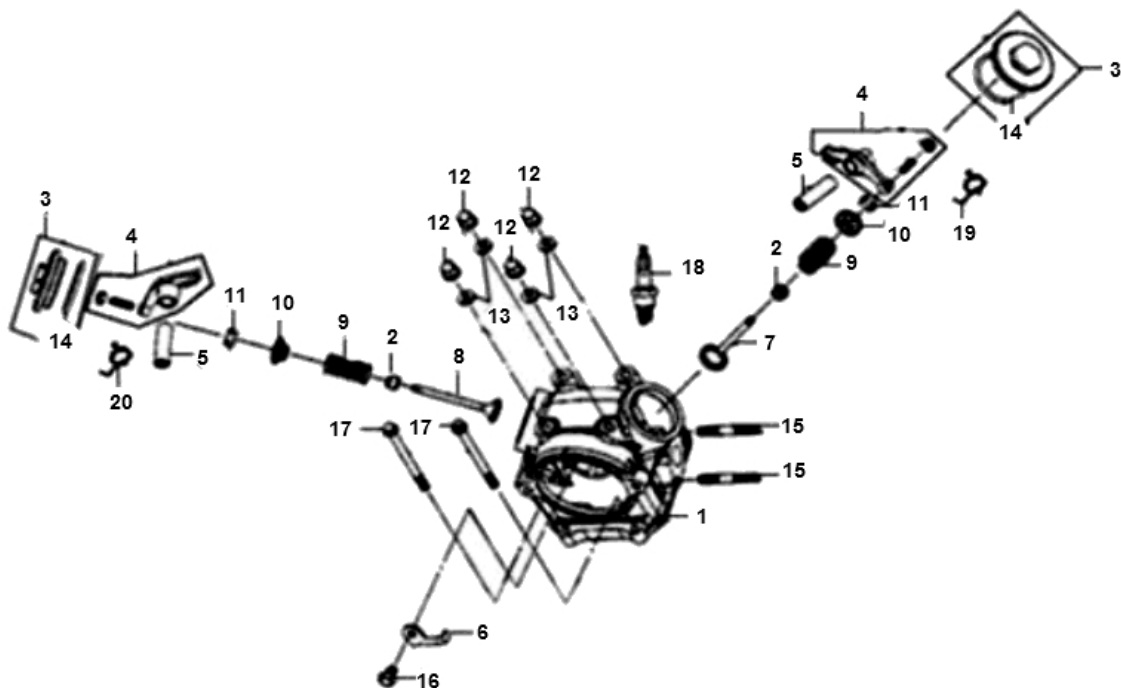

Verzeichnis	Artikelnummer	Beschreibung
01	21448	ZYLINDERKOPF PEUGEOT/SYM 4T (new engine) ORG
02	801408	VENTIL SEAL SYM MIO/ PEUGEOT 4T NT ORG (1)
03	801409	VENTIL DECKEL SYM MIO/PEUGEOT 4T NT (SP) 42mm
04	801410	KIPPEBEL PEUGEOT/SYM 4T (new engine) ORG
05	21450	KIPPEBEL ACHSE SYM MIO ORG
06	801413	SICHERUNGSBLECH NOCKENWELLE SYM MIO PEU 4T NT
07	21451	VENTIL EINLASS PEUGEOT/SYM 4T (new engine) ORG
08	21452	VENTIL AUSLASS PEUGEOT/SYM 4T (new engine) ORG
09	801416	PEUGEOT / SYM MIO 4T NT VENTIELFEDER ORG
10	801417	PEUGEOT VENTIELFEDER BUCHSE
11	802055	DEMI CONE PEUGEOT/SYM 4T (new engine) ORG (1)
12	10193	HUTMUTTER CHROME M 6 x 1.00 10 stuck
13	10150	KUPFERRING 6x10mm 10 stuck
14	801419	PEUGEOT/SYM MIO O-RING 41x2.6
15	5637	KRÜMMER/BOLZEN UNI M6x30mm
16	89554	FLANSCH MOTOR SCHRAUBEN SW 8 M6x15 SCHWARZ 10st
17	801421	PEUGEOT BOLZEN M6x1.00-80
18	89892	ZÜNDKERZE NGK CR 6HSA (1)
19	801424	PEUGEOT KIPPEBEL FEDER SYM MIO
20	801424	PEUGEOT KIPPEBEL FEDER SYM MIO